

## TECHNICAL SERVICE PARTS LIST

### OPERATING INSTRUCTIONS:

- Flow Rating at 100 PSI (7 BAR)
- Open and Close Slowly
- Maximum Operating Pressure 200 PSI (14 BAR)

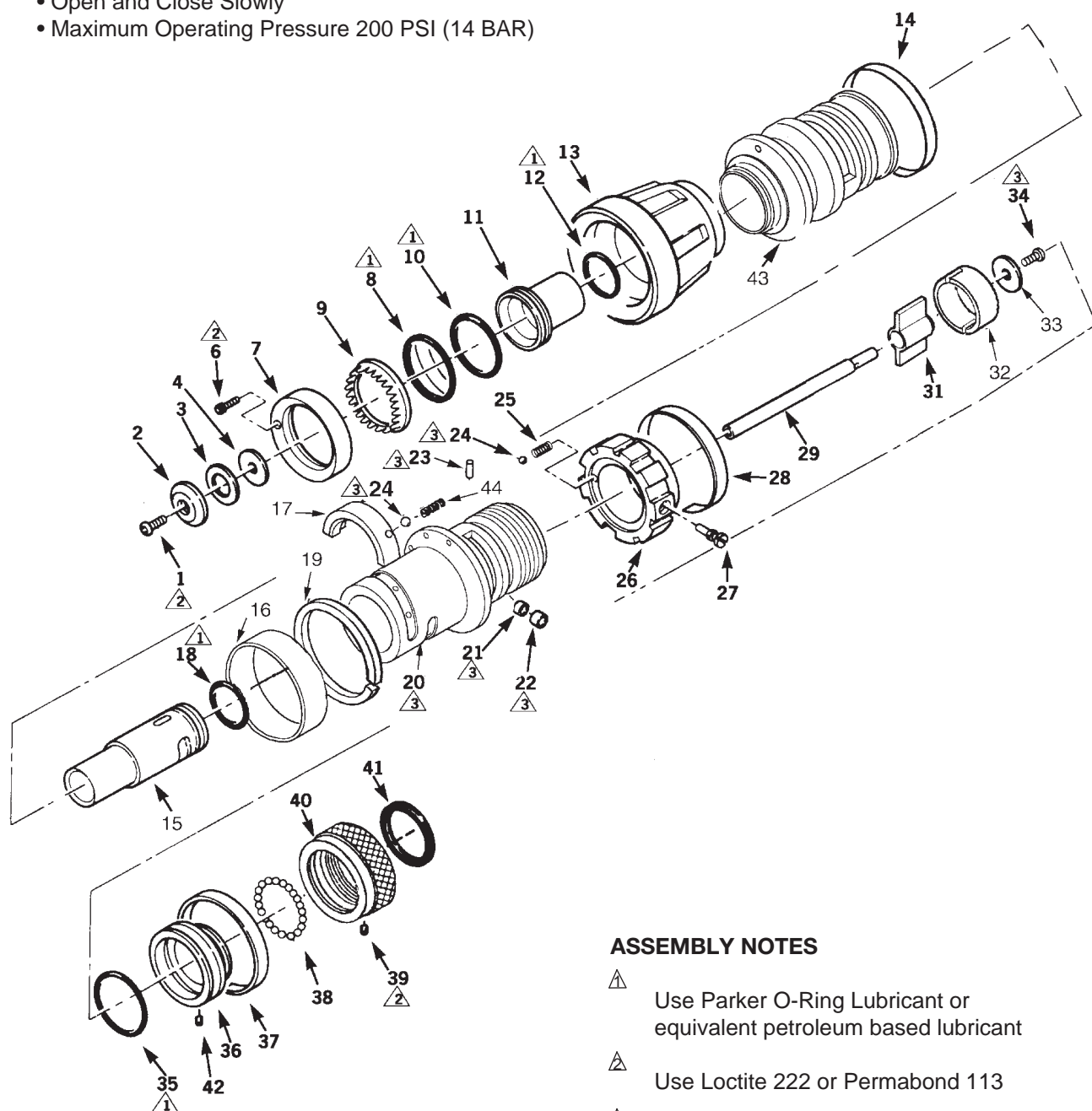

### ASSEMBLY NOTES

- △ Use Parker O-Ring Lubricant or equivalent petroleum based lubricant
- △ Use Loctite 222 or PermaBond 113
- △ Use Low-Temp Lubriplate™

## TECHNICAL SERVICE PARTS LIST

ITEM NO.	DESCRIPTION	PART NUMBER	QUANTITY
1	Flat Head Screw	7-60-040	1
2	Gasket Retainer	102232	1
3	Baffle Gasket	7-17-046	1
4	Baffle Head (100 PSI)	102231	1
4	Baffle Head (75 PSI)	118815	1
6	Socket Head Cap Screw	7-67-094	2
7	Turbine Retaining Ring	7-58-183	1
7**	Turbine Retaining Ring (for Metal Teeth)	7-58-252	1
8	O-Ring	7-57-280	1
9	Turbine Teeth (Delrin)	7-72-136	1
9**	Turbine Teeth (Metal)	118814	1
10	O-Ring	7-57-244	1
11	Throat (100 PSI)	117174	1
11	Throat (75 PSI)	118818	1
12	O-Ring	7-57-245	1
13	Bumper Assembly	7-03-388	1
14	Pattern Indicating Band (100 PSI)	7-04-885	1
14	Pattern Indicating Band (75 PSI)	7-04-836	1
15	Discharge Tube (100 PSI)	117175	1
15	Discharge Tube (75 PSI)	118817	1
16	Ring	7-54-057	1
17	Insert	7-07-395	1
18	O-Ring	7-57-242	1
19	Ring Retainer	7-58-223	1
20	Nozzle Body (100 PSI)	117171	1
20	Nozzle Body (75 PSI)	118816	1
21	Cam Roller – Short	7-58-210	1
22	Cam Roller – Long	7-58-211	1
23	Key Pin	7-27-034	1
24	Detent Ball	7-04-018	3
25	Detent Spring	7-69-283	2
26	Discharge Control Ring	7-58-182	1
27	Cam Axle	7-07-252	1
28	Discharge Control Band – GPM (100 PSI)	7-04-822	1
28	Discharge Control Band – GPM (75 PSI)	7-04-835	1
28	Discharge Control Band – LPM (7 BAR)	7-04-821	1
29	Stem	119332	1
31	Spider	7-68-296	1
32	Spider Retainer	116903	1
33	Washer	7-84-094	1
34	Nut	7-34-061	1
35	O-Ring	7-57-232	1
36	Swivel Adapter	117172	1
37	I.D. Band	7-04-285	1
38	Locking Balls	*	42
39	Set Screw	7-65-008	1
40†	Swivel (NH)	108313	1
40†	Swivel (NPSH)	108314	1
41	Swivel Gasket	7-17-042	1
42	Set Screw	7-65-040	1
43	Pattern Sleeve	117173	1
44	Detent Spring	7-68-283	2
45**	Turbine Bearing (for Metal Teeth) NOT SHOWN	7-04-705	1

†For other threads order by description and thread size (ODM and TPI) or by Thread Code.

\*Packet of 50 Locking Balls - P/N 109042

\*\*To convert Turbine Teeth from Delrin to Metal, Items 7, 9 and 45 must be used.