



Instruction Manual

XPP-5570R

THANK YOU FOR SELECTING THE NIGHTSTICK XPP-5570R
INTRINSICALLY SAFE PERMISSIBLE ANGLE LIGHT!

PLEASE SAVE THESE INSTRUCTIONS

Please read these instructions before using your Nightstick XPP-5570R Intrinsically Safe Permissible Angle Light. They include important safety information and operating instructions.

THE XPP-5570R IS APPROVED FOR USE

Permissible Nightstick XPP-5570 Flashlight/Floodlight



APPROVAL No. 20-A150005-0

TESTED FOR INTRINSIC SAFETY IN METHANE-AIR MIXTURES ONLY

WARNINGS: Do not charge in hazardous location. MSHA approved for use with Bayco Li-ion Battery Pack 5572-BATT or Primary 5570-BATT Battery Pack containing 6 AA Energizer Type EN91 or L91 batteries. Replace the Battery Pack in fresh air only. Do not mix batteries from different manufacturers or different types. Battery Pack to be replaced by a qualified technician only. The Model Nightstick 5570 must not be opened in areas where permissibility is required. Substitution of components may impair Intrinsic Safety.



Ex ia FLASHLIGHT FOR USE IN HAZARDOUS LOCATIONS

UL listed for use with Bayco Li-ion Battery Pack 5572-BATT or Primary 5570-BATT Battery Pack containing 6 AA Energizer Type EN91 or E91 batteries.

CLASS I DIV I GRPS A-D T3
CLASS II & III DIV I GRPS E-G
CLASS I ZONE 0 Group IIC T3
CLASS II ZONE 20 Group IIIC T3
-20°C ≤ Tamb ≤ +70°C

WARNINGS - INTRINSICALLY SAFE

- WARNING: Use only the approved non-rechargeable batteries listed below.
- WARNING: Do NOT attempt to use rechargeable AA batteries with this light.
- WARNING: To prevent ignition of a hazardous atmosphere, do not open the battery compartment in the hazardous environment. This task must ONLY be performed in an area known to be non-hazardous.
- WARNING: When exchanging batteries, use only **Energizer EN91** or **Energizer E91** batteries.
- WARNING: To prevent ignition of a hazardous atmosphere, the AA batteries must only be exchanged in an area known to be non-hazardous.
- WARNING: To reduce the risk of explosion, do not mix new non-rechargeable batteries with used non-rechargeable batteries, or mix non-rechargeable batteries from different manufacturers.
- WARNING: Substitution of components may impair intrinsic safety.

SPECIAL INSTRUCTIONS FOR INTRINSIC SAFETY

- For personal safety, always confirm the rating of any known hazardous or potentially hazardous location where the Angle Light is to be used.

POWERING THE XPP-5570R

The XPP-5570R Intrinsically Safe Light is powered by the Nightstick 5570-BATT Non-Rechargeable Battery Carrier and 6 - AA **Energizer EN91** or **Energizer E91** Batteries.

WARNING: Do not use any other type of non-rechargeable battery with this light.

WARNING: Do not use rechargeable AA batteries with this light.



Included in the box - Compris dans la boîte - Incluido en la caja

WARNING: The Nightstick 5570-BATT Non-Rechargeable Battery Carrier is a proprietary shape and design and will only fit in the XPP-5570R or XPR-5572R Angle Lights. Do not attempt to use this battery pack in any other light. Do not attempt to use any other battery pack in this light.

- The Nightstick 5570-BATT Non-Rechargeable Battery Carrier is designed to fit 6 AA batteries. In order to maintain the XPP-5570R's Intrinsically Safe Permissible rating, the only AA batteries certified for use with this light are the **Energizer EN91** or **Energizer E91**.
- Do not attempt to use any other brand or model of AA batteries with this light.
- Do not attempt to use any type of rechargeable AA batteries with this light.

Removing the Non-Rechargeable Battery Carrier

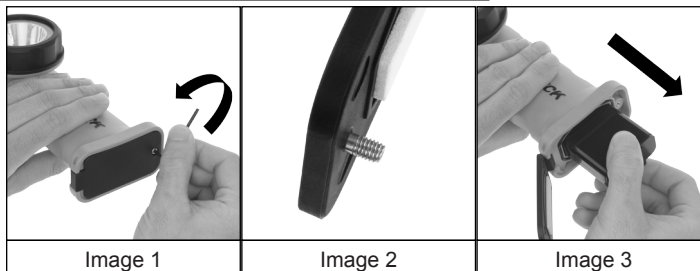

WARNING: To prevent ignition of a hazardous atmosphere, do not open the battery compartment in the hazardous environment. This task must ONLY be done in an area known to be non-hazardous.

- To access the 5570-BATT Non-Rechargeable Battery Carrier, unscrew the Torx Head Screw located on the Battery Compartment Door on the base of the light using the included Torx Head Wrench. (Image 1)

NOTE: The Battery Compartment Door Torx Screw utilizes a design that prevents the screw from falling out of the door. Do not attempt to remove the screw. (Image 2)

- Open the Battery Compartment Door with enough clearance to allow the 5570-BATT Non-Rechargeable Battery Carrier to slide out. (Image 3)

Installing or replacing the batteries

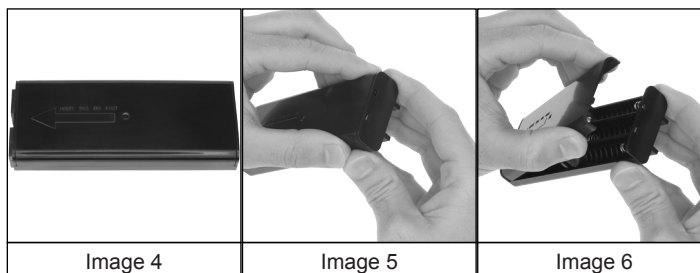

QUALITY AND INNOVATIVE FIRE AND RESCUE EQUIPMENT

Bayco Products, Inc. • 640 South Sanden Blvd. • Wylie, TX 75098 • 1-800-233-2155 • 1-469-326-9400 • www.mynightstick.com



www.bigredtruck.com.au

- Begin by positioning the 5570-BATT Non-Rechargeable Battery Carrier with the arrow pointing to the left. (Image 4)
- Using the thumb and index finger, squeeze in on the two sides of the carrier cover closest to the right end of the carrier. (Image 5)
- This action will cause the tabs on the right end of the cover to release from the base and allow the cover to simply lift away. (Image 6)
- Using 6 – AA **Energizer EN91** or **Energizer E91** (make sure that all 6

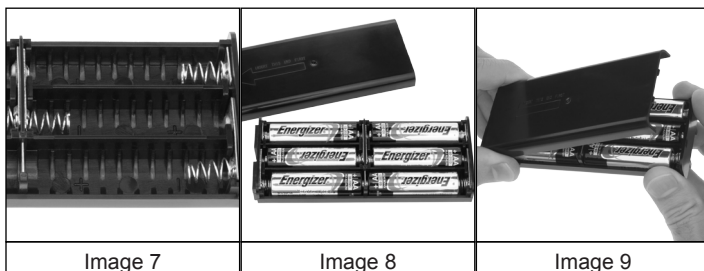

batteries are of one or the other model...do not use a combination of the two), install the batteries per the diagram located on the inside base of the battery carrier. (Image 7)

- Take care not to bend any of the battery contact springs, and to make sure that all 6 batteries are properly seated before reinstalling the cover. (Image 8)
- To reinstall the cover, insert the two tabs on the left-hand end of the cover into the two corresponding slots on left end of the base. (Image 9)

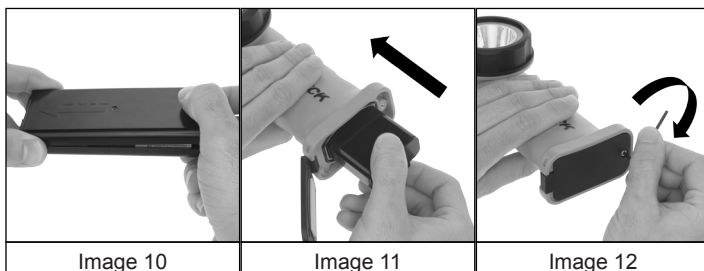

- While keeping the left-hand tabs in their slots, gently press down on the right side of the cover until the two right-hand tabs slip into their respective slots. (Image 10)

NOTE: The battery carrier cover will only fit one way. It is not possible to install it in a reversed position.

The 5570-BATT Non-Rechargeable Battery Carrier is ready to install into the Angle Light.

Installing the Non-Rechargeable Battery Carrier

- With the Battery Compartment Door opened enough to provide clearance, insert the 5570-BATT Non-Rechargeable Battery Carrier with the end having the metal contacts on it being inserted first and the rails on the bottom of the battery carrier positioned toward the back of the light. (Image 11)
- With the battery carrier fully inserted into the handle of the light, close the Battery Compartment Door and secure it in place with the Battery Compartment Door Screw and the included Torx Wrench. (Image 12)

WARNING: Do not over-tighten the Battery Compartment Door Screw.

OPERATION

THE XPP-5570R HAS EIGHT SEPARATE LIGHTING MODES:

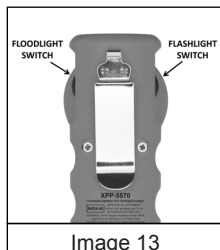

- High-brightness Flashlight
- Medium-brightness Flashlight
- Survival-mode Flashlight
- Flashlight Strobe
- High-brightness Floodlight
- Medium-brightness Floodlight
- Survival-mode Floodlight
- Dual-Light (both the Flashlight and Floodlight on at the same time)

Flashlight Modes

To activate the Flashlight, press and release the Flashlight Switch (Image 13). The default mode will be High-brightness. To select the brightness level for the Flashlight, press and hold the Flashlight Switch. The flashlight will cycle from high to medium to Survival and then back up again at a rate of approximately one mode per second. The light will continue to cycle up and down through the various modes as long as the switch is held down. When the desired brightness level is reached, simply release the Flashlight Switch, and the light will remain in that brightness mode. To turn the Flashlight off, press and release the Flashlight Switch one more time.

Strobe

To activate the Strobe, double click the Flashlight Switch (Image 13). To turn the Strobe off, press and release the Flashlight Switch one more time.

Floodlight Modes

To activate the Floodlight, press and release the Floodlight Switch (Image 13). The default mode will be High-brightness. To select the brightness level for the Floodlight, press and hold the Floodlight Switch. The floodlight will cycle from high to medium to Survival and then back up again at a rate of approximately one mode per second. The light will continue to cycle up and down through the various modes as long as the switch is held down. When the desired brightness level is reached, simply release the Floodlight Switch, and the light will remain in that brightness mode. To turn the Floodlight off, press and release the Floodlight Switch one more time.

Dual-Light Mode

Dual-Light mode allows the user to turn on both the Flashlight and the Floodlight at the same time. Dual-Light mode can be activated by simply pressing the Flashlight Switch and then the Floodlight Switch or the Floodlight Switch and then the Flashlight Switch (Image 13). If the Angle Light already has the Flashlight or the Floodlight on (regardless of what brightness mode that light is in), pressing the switch for the light that is NOT on, will activate Dual-Light mode. The user can leave Dual-Light mode and go back to either Flashlight or Floodlight mode simply by pressing the switch for the mode that they wish to turn off. To turn both lights off, simply press each of the switches independently.

BAYCO PRODUCTS LIMITED LIFETIME WARRANTY

WARRANTY

Bayco Products, Inc. warrants this product to be free from defects in workmanship and materials for the original purchaser's lifetime. The Limited Lifetime Warranty includes the LEDs, housing and lenses. Rechargeable batteries, chargers, switches, electronics and included accessories are warranted for a period of two years with proof of purchase. Disposable, non-rechargeable batteries are excluded from this warranty. Normal wear and failures which are caused by accidents, misuse, abuse, faulty installation and lightning damage are also excluded.

In the event that Bayco Products, Inc. receives notice that any product does not conform to its warranty, the original purchaser's sole and exclusive remedy, and Bayco Products, Inc.'s sole and exclusive liability, shall be for Bayco Products, Inc., at its sole option, to either repair or replace the non-conforming product in accordance with this limited warranty. The original purchaser shall follow the instructions below to qualify for a repair or replacement product. This is the only warranty, expressed or implied, including any warranty of merchantability or fitness for a particular purpose.

IN NO EVENT WILL BAYCO PRODUCTS, INC. OR ITS AFFILIATES OR SUPPLIERS BE LIABLE FOR ANY INDIRECT, SPECIAL, INCIDENTAL OR CONSEQUENTIAL DAMAGES OF ANY KIND REGARDLESS OF THE FORM OF ACTION, WHETHER IN CONTRACT, TORT (INCLUDING NEGLIGENCE), STRICT LIABILITY OR OTHERWISE. THE TOTAL CUMULATIVE LIABILITY TO CUSTOMER, FROM ALL CAUSES OF ACTION AND ALL THEORIES OF LIABILITY, WILL BE LIMITED TO AND WILL NOT EXCEED THE PURCHASE PRICE OF THE PRODUCT PAID BY CUSTOMER.

If this product is used for rental purposes, the warranty term is reduced to 90 days from the date of purchase.

WARRANTY CLAIMS – USA

Return the product to the place of purchase for all warranty related issues. If this is not possible, contact Bayco Customer Service at (800) 233-

Bayco Products, Inc. • 640 South Sanden Blvd. • Wylie, TX 75098 • 1-800-233-2155 • 1-469-326-9400 • www.mynightstick.com



www.bigredtruck.com.au

2155 M-F 8-5 Central Time for a Return Goods Authorization (RGA). Do not return this product to Bayco without first receiving an RGA Number from Bayco Customer Service. When returning the product, the RGA Number must be written on the outside of the shipping box.

WARRANTY CLAIMS – OUTSIDE OF USA

Return the product to the place where purchased for all warranty related issues.

EXTENT OF COVERED WARRANTY WORK

Bayco will repair or replace this product at our option. If it is determined that the warranty is no longer in effect, Bayco will contact you with a repair estimate before beginning any work.

WARRANTY QUESTIONS

If you have any questions about this warranty or any other Bayco product inquiries, please contact Bayco Customer Service at (800) 233-2155 M-F 8-5 Central Time.

RECORD YOUR WARRANTY INFORMATION

Please record your XPP-5570R product information here for use with any warranty claim.

Serial Number _____

Date of Purchase _____

QUALITY AND INNOVATIVE FIRE AND RESCUE EQUIPMENT



www.bigredtruck.com.au